

Bon Accord Community School
School Year Plan
2021 - 2022



Last Updated August 25, 2021

This document is subject to change and will continue to be updated based on orders from the Chief Medical Officer of Health and Alberta Education.

[GoA Preparing for a new School Year Website link](#)

Return to School Plan

Table of Contents

Table of Contents..... 2

School Operations – what school will look like..... 3

 Cleaning..... 3

 Exterior School Doors 3

 Student Arrival and Entry 3

 Student Flow within the school..... 3

 Masks..... 4

 Student Groups/Cohorts..... 4

 Recess/Breaks/Playgrounds 4

 Playground use - before and after school 4

 Snack and Lunch time 4

 Food Handling 5

 Physical Education 5

 Music..... 5

 Library..... 5

 End of School Day..... 5

 Extra-Curricular Activities 5

 Supplies and Storage 6

 Washrooms 6

 Hand sanitizing..... 6

 Illness at School..... 6

Early Childhood Education - Staggered Entry Guidelines 7

Early Childhood Education – Regular Guidelines..... 7

School Map..... 8

Please refer to the SPS Back to School Plan for Division Guidelines

[Sturgeon Public Schools 2021 -2022 Back to School Plan](#)

Government Guidelines for School Re-entry:

[Alberta K-12 School Re-Entry Website](#)

[Alberta Guidance for Schools \(K-12\) and Buses – Scenario 1](#)

Return to School Plan

School Operations – what school will look like

Cleaning

Bon Accord Community School will continue to follow enhanced COVID-19 routine cleaning requirements, including regular cleaning and disinfecting of high touch surfaces. Caretaking staff will maintain schools within SPS's pandemic cleaning protocol. Information on Transportation protocols can be found on the SPS Back to School Plan – page 10.

Exterior School Doors

School doors will remain locked throughout the school day. Supervisors will open doors at the start of the day to allow students into the building.

To reduce the risk of transmission of COVID-19 or other respiratory illnesses, parents and guardians are asked to remain outside the school when dropping off their child and asked to not enter the school unless approved by the Principal. If someone is required to enter the school during the day, they either need to make an appointment ahead of time, or call the school while waiting at the front door and someone will let them in. Masks and following physical distancing practices are highly recommended.

All visitors must book an appointment prior to coming to the school. They will be required to scan a QR code (located on the front doors) with their smartphone before they enter the school.

Student Arrival and Entry

All classes have assigned doors for entrances (see attached map).

Students arriving by bus will remain on the bus until they are given instruction to exit the bus and enter their appropriate door into the school.

Students arriving via walking or parent drop-off will remain at the 'Parent Pickup Zone' until 8:30am. When the bell rings, students will go to their assigned door (see attached map). Students are encouraged not to arrive at school until 8:30am.

Students who arrive late must enter the school through the front door. They will sign in at the front office and then go directly to their classroom.

Only staff and students may enter the school. Parents may bring their child(ren) to their assigned door outside of the school.

Hand sanitizer stations will be set-up at every entrance door. Kindergarten to Grade 4 students will be supervised by staff as they use the hand sanitizer. This will be done upon entering and leaving the building or a room.

General guidelines for Student Arrival and Entry are listed in the SPS Back to School Plan - page 7.

Student Flow within the school

Wall posters and or hallways arrows will be used for directional walking - students will always walk on the right-hand side of the hallway and will not cross the hallway unless they

Return to School Plan

are entering a classroom.

Occupancy posters and floor decals will be used to support distancing.

Masks

Alberta does not have a mask requirement in schools; however, masks may be recommended temporarily if there is a respiratory illness outbreak at a school.

Sturgeon Public Schools will support individuals who choose to wear masks. Students, staff, visitors, and parents/guardians should consider their own risks and their personal situation when making decisions on wearing a mask. It is reasonable that in some settings, an individual may choose to wear a mask while we are getting back to normal.

Students, teachers, staff, and visitors must follow provincial requirements for masks:

- Masks remain mandatory for students, teachers, staff members and visitors on school buses and publicly accessible transit, such as municipal buses, taxis, and ride-shares.
- Exceptions to the mask requirement on school buses are listed in CMOH Order 34-2021.

Student Groups/Cohorts

Cohorts are not required but are encouraged for the 2021-2022 school year and may be required temporarily to prevent the spread of infection if there is a respiratory illness outbreak at school. If cohorts become required, student cohorts will be made up of students from the same classroom.

Recess/Breaks/Playgrounds

Students will practice proper hand hygiene before and after using the playground. They are encouraged to stay within their cohort during these times. If students from two different cohorts wish to socialize, they are encouraged to stay 2 meters apart.

Toys and sports equipment will be available for use on the playground. They will be cleaned and disinfected before and after each use, and users will perform hand hygiene before and after each use.

General guidelines for cohorts and playground use are listed in the SPS Back to School Plan - page 7 and 8.

Playground use - before and after school

The school will not be assigning staff to supervise playground equipment before and after school. To support safety, this equipment will be off limits to students during these times. Families who wish to take children to the playground at other times of the day are encouraged to follow the province's guidelines to use the equipment as safely as possible.

Snack and Lunch time

Students are encouraged to bring food in containers (disposable or reusable) that they can open themselves. All food will be eaten at individual desks. Students are encouraged to not share utensils, dishes, water bottles or drink containers.

Return to School Plan

Students will be asked to wash their hands or use hand sanitizer before and after eating. They may be asked to help wipe down their own desks or tables used for eating.

Food Handling

The Breakfast Program will be running at Bon Accord Community School for the 2021-2022 school year. Designated volunteers helping to run the program will be required to wear masks and practice proper hand hygiene.

Hot Lunch Programs will resume provided we have resources and volunteers.

General guidelines for breakfast/lunch/snack programs are listed in the SPS Back to School Plan - page 9.

Physical Education

Physical education classes will be taking place. As frequently as possible, outdoor classes will be encouraged to encourage social distancing. Students must be dressed appropriately for the weather.

Students will follow hand washing/sanitizing procedures when entering and exiting the gymnasium. Equipment will be sanitized regularly.

Music

Music classes will take place in the music room. Physical distancing during performance activities (like singing) will be encouraged.

Library

Students will hand sanitize before entering the library. All high touch surfaces will be disinfected between classes.

End of School Day

Students will remain in their classroom until they are dismissed. Students will exit the building through their designated doors.

Students being picked up by parents will meet at the 'Parent Pickup Zone' outside (see attached map). Parents and guardians are asked to remain outside the school while waiting for their children and to not enter the school unless approved by the Principal.

Students who travel by bus will be dismissed individually and must go directly to their assigned bus.

Once students are dismissed, they are to immediately leave school property.

General guidelines for the End of School Day are listed in the SPS Back to School Plan - page 8.

Extra-Curricular Activities

All Sturgeon Public Schools extra-curricular athletics and fine arts performances will resume. More information is included in the SPS Back to School Plan - page 8.

Return to School Plan

Supplies and Storage

Staff and students are encouraged to utilize their own personal items (e.g., electronic devices, writing instruments, school supplies and minimize any shared items. Students may be asked to help clean any shared resources after individual use.

Hallway lockers will be accessible; however, students are encouraged to keep non-essential items at home.

Washrooms

Each classroom is assigned to a specific bathroom. Bathrooms will have a 4-person maximum use policy to encourage physical distancing.

Students will be able to use their assigned classroom bathroom at any time during the school day, one at a time from each classroom, and will adhere to the maximum use rule posted.

This will be monitored by staff as needed throughout the day. Students waiting are encouraged to practice physical distancing in the hallway.

Hand sanitizing

Students will be expected to use hand sanitizer every time they enter the school building and before they enter any room. Students will be expected to wash their hands before and after eating.

Illness at School

Parents or guardians **must assess their children daily**, before leaving home, for symptoms of common cold, influenza, COVID-19 or other infectious respiratory diseases and **keep their child(ren) home if they are sick**. Any person entering the school must self screen using the applicable [checklist](#) for their age group.

As outlined by the Government of Alberta in the [COVID - 19 Guidance for Schools Scenario 1](#), a record of a student's pre-existing conditions will be kept. If a student develops symptoms that could be caused by either COVID-19 or by a known pre-existing condition (e.g., allergies), the student should be tested at least once for COVID-19 to confirm that it is not the source of their symptoms before entering or returning to school. This will be considered the student's baseline health. Written confirmation by a physician that a student's symptoms are due to a chronic illness is NOT necessary. Repeat testing is NOT indicated unless the nature of the symptom changes (e.g., chronic cough worsens).

Students exhibiting signs of illness will be moved to the school's infirmary room. Parents/guardians will be notified and advised to pick-up their child. If the parent/guardian is unable to pick up their child, they must designate an emergency contact for student pickup. It is the expectation that students are picked up by the family or emergency contact. This is outlined in the SPS Back to School Plan – page 5.

Proof of a negative COVID-19 test result is not necessary for a student to return to school; however, individuals should not return to the school until they are feeling well.

Should a child need to stay home for a period due to illness, classroom teachers will provide key work for the student to be able to work on while at-home. Homework bundles or tasks would be provided to the student by the regular teacher, but they would not be

Return to School Plan

engaging in at-home learning as was provided through Continuity of Learning.

General guidelines for confirmed cases of COVID-19, absenteeism and isolation requirements are listed in the SPS Back to School Plan - pages 5 & 6.

Early Childhood Education and Kindergarten - Staggered Entry Guidelines

Children will begin staggered entry as per usual practice and outlined by the teacher.

Early Childhood Education – Regular Guidelines

***Will follow the school guidelines**

- Regular sanitization of materials (toys, manipulatives) and furniture.
- Students will be taught regular handwashing and proper hygiene with visuals and modelling.

Return to School Plan

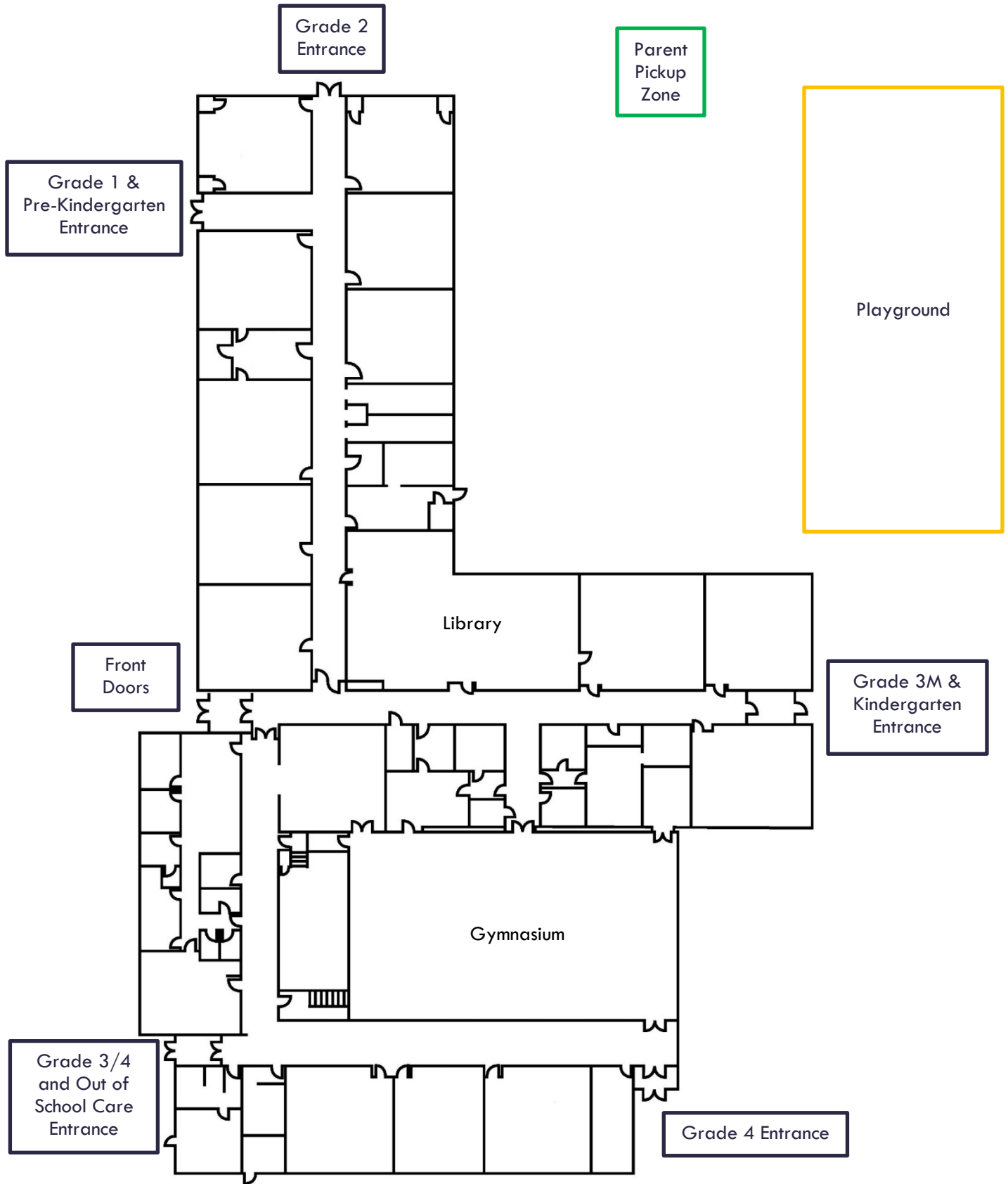

**Bon Accord Community School
Entrance Map**